



FITTING INSTRUCTIONS FOR CP0424BL
AERO CRASH PROTECTORS
SUZUKI GSX-S 750 2017



Picture A



Picture B

THIS KIT CONTAINS THE ITEMS PICTURED AND LABELLED BELOW.
DO NOT PROCEED UNTIL YOU ARE SURE ALL PARTS ARE PRESENT.

Please note that the way the kit is packed does not necessarily represent the way of mounting to the bike.

THE PARTS SHOWN MAY BE REPRESENTATIVE ONLY (FOR CLARITY OF INSTRUCTIONS ONLY).

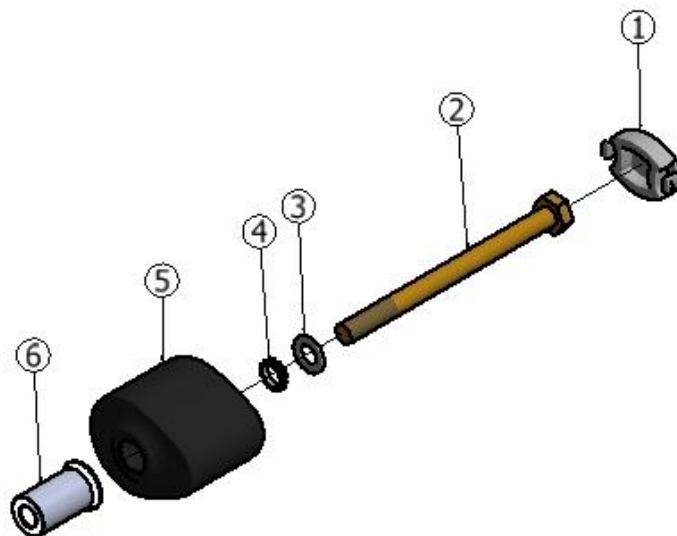

RIGHT SIDE

R&G Racing

Unit 1, Shelley's Lane, East Worldham, Alton, Hampshire, GU34 3AQ

Tel: +44 (0)1420 89007 Fax: +44 (0)1420 87301 www.rg-racing.com Email: info@rg-racing.com

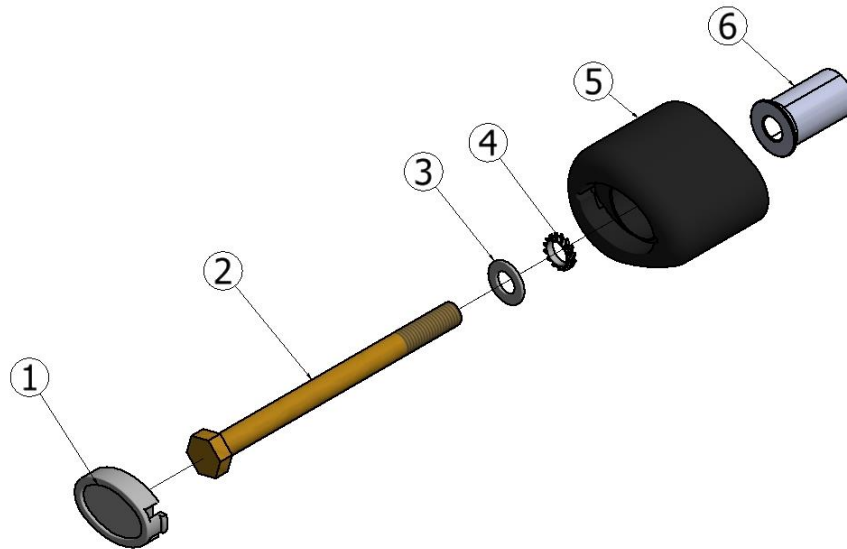

LEFT SIDE

LEGEND

- ITEM 1 = CRASH PROTECTOR CAPS (BC0002) (x2).
 ITEM 2 = M10 x 1.25 x 105mm LONG HEX HEAD BOLT (x2).
 ITEM 3 = M10 WASHERS (x2).
 ITEM 4 = LOCK-WASHERS (LW0001) (x2).
 ITEM 5 = CRASH PROTECTOR BOBBINS (B0063 with CS066) (x2).
 ITEM 6 = SPACER (S0499 – 35mm LONG) (x2).

Please note that in cases where kits are packed with rubber washers holding the components onto the bolt – *the rubber washers should be thrown away!*

TOOLS REQUIRED

- M8 Allen Key.
- Socket set to include 17mm socket and wrench.
- Torque wrench (up to 40N/m).

TOWARDS REAR
OF BIKE

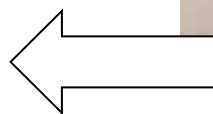

TOWARDS FRONT
OF BIKE

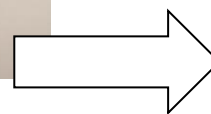

PICTURE C



GENERAL TORQUE SETTINGS

M4 BOLT = 8Nm
 M5 BOLT = 12Nm
 M6 BOLT = 15Nm
 M8 BOLT = 20Nm
 M10 BOLT = 40Nm



PICTURE 1

FITTING INSTRUCTIONS

- Starting from the RHS, remove the front engine mounting bolt and the washer using an 8mm Allen Key (Arrowed in picture 1).
- Slide one of the 10mm washers (item 3) onto the M10 x 105mm long hex head bolt (item 2) so the washer sits against head of bolt.
- Slide one serrated locking washer (item 4) over the bolt so it sits against the washer just fitted.
- Next slide the bolt with washers through either crash protector bobbin (item 5) so the head of the bolt and washers go into the counter-bore in.
- Place the spacer (Item 5) onto the exposed end of the bolt, ensuring the larger diameter sits against the crash bobbin.
- Check the assembly matches the exploded diagram on page 1 and offer the assembly up to the bike as shown in the pictures on page 1.
- Tighten the crash protector bolt until you feel some compression from inside the protector using a 17mm socket and wrench. **PLEASE NOTE THE CRASH PROTECTOR MUST BE POSITIONED AS IN PICTURE 'C' WITH BIGGER END TOWARD FRONT OF BIKE.** Turn a little more so that you feel the compression increase slightly. Then apply a quarter turn. Do not over tighten as damage can occur to the bike. Do not exceed 40N/m of torque.
- Repeat the above procedure to fit the remaining crash protector to the left side of the bike, using the remaining bolt and spacer.
- If not already fitted, fit bubble stickers into recess of both crash protector caps.
- Fit crash protector caps (Item 6) into both crash protectors.

ISSUE 1 19/04/2017 (HH)

Digital copies of these instructions are available to download from www.rg-racing.com

R&G Racing

Unit 1, Shelley's Lane, East Worldham, Alton, Hampshire, GU34 3AQ

Tel: +44 (0)1420 89007 Fax: +44 (0)1420 87301 www.rg-racing.com Email: info@rg-racing.com



CONSUMER NOTICE

The catalogue description and any exhibition of samples are only broad indications of the Products and R&G may make design changes which do not diminish their performance or visual appeal and supplying them in such state shall conform to the order. The Buyer acknowledges no representation or warranty (other than as to title) has been given or will apply to the Products other than those in R&G's order or confirmation and the Buyer confirms it has chosen the Products as being of merchantable quality and suitable for its particular purposes. Where R&G fits the Products or undertakes other services it shall exercise reasonable skill and care and rectify any fault free of charge unless the workmanship has been disturbed. The Buyer is responsible for ensuring that the warranty on the motorcycle is not affected by the fitting of the Products. On return of any defective Products R&G shall at its option either supply a replacement or refund the purchase money but shall not be liable if the Products have been modified or used or maintained otherwise than in accordance with R&G's or manufacturer's instructions and good engineering practice or if the defect arises from accident or neglect. Other than identified above and subject to R&G not limiting its liability for causing death and personal injury, it shall not be liable for indirect or consequential loss and otherwise its liability shall be limited to the amounts paid by the Buyer for the Products or the fitting or service concerned. These terms do not affect the Buyer's statutory rights.

R&G RACING RETURNS POLICY (NON-FAULTY GOODS)

Returns must be pre-authorized (if not pre-authorized the return will be rejected). Goods may only be returned direct to us if they were purchased direct from us (customer must prove if necessary). Otherwise to be returned to original vendor. Goods must be in re-sellable condition, in the opinion of R&G Racing. All returns are subject to a 25% restocking and handling fee (25% of the gross value exc. P&P – at the prevailing price at time of purchase). The customer must pay any and all carriage charges. No returns of discontinued products, unless within 14 days of purchase. This policy does not affect your statutory rights and does not refer to faulty goods.



NOTICE DE MONTAGE CP0424BL
PROTECTIONS CRASH LATERALES
SUZUKI GSX-S 750 2017



Photo A

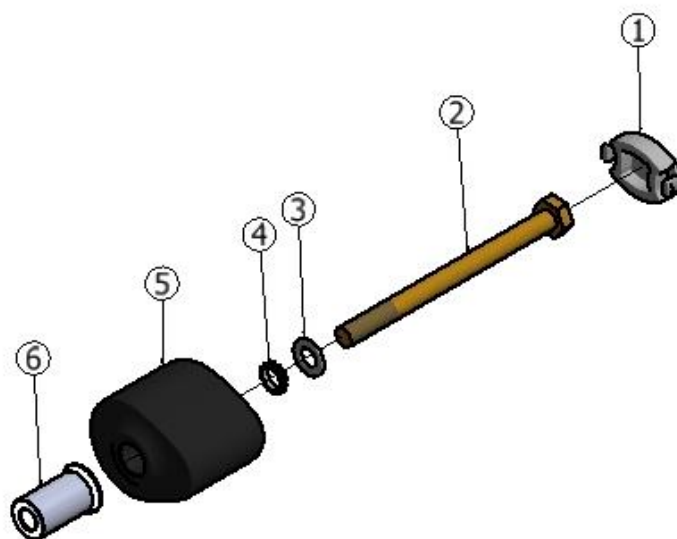

Photo B

Le kit contient les articles exposés ci-dessous, vérifier que toutes les pièces soient présentes avant de procéder au montage.

La façon dont le kit est emballé ne correspond pas forcément à la façon de monter les pièces sur la moto.

LES PARTIES PRESENTEES PEUVENT ETRE UNIQUEMENT REPRESENTATIVES (POUR LA CLARTE DES INSTRUCTIONS UNIQUEMENT).





COTE DROIT

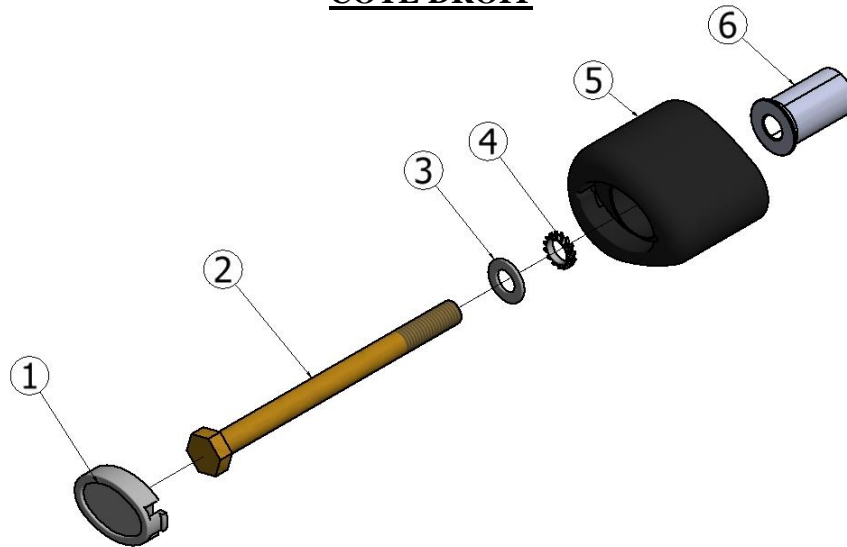

COTE GAUCHE

LEGENDE

ARTICLE 1 = CAPUCHONS DE PROTECTION CRASH (BC0002) (x2).

ARTICLE 2 = M10 x 1.25 x 105mm BOULON (x2).

ARTICLE 3 = M10 RONDELLES (x2).

ARTICLE 4 = RONDELLES DE BLOCAGE (LW0001) (x2).

ARTICLE 5 = BOBINES DE PROTECTION CRASH (B0063 avec CS066) (x2).

ARTICLE 6 = ENTRETOISE (S0499 – 35mm DE LONG) (x2).

Notez que si les kits sont emballés avec des rondelles en caoutchouc servant à tenir les composants, *ces rondelles doivent être jetées!*

OUTILS REQUIS

- Clé Allen M8.
- Clé à cliquet + douille 17mm.
- Clé dynamométrique (à 40N/m).

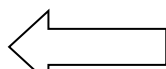

ARRIÈRE MOTO

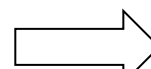

AVANT MOTO

PHOTO C

R&G Racing

Unit 1, Shelley's Lane, East Worldham, Alton, Hampshire, GU34 3AQ

Tel: +44 (0)1420 89007 Fax: +44 (0)1420 87301 www.rg-racing.com Email: info@rg-racing.com



Couples de serrage recommandés

M4 BOULON = 8Nm
 M5 BOULON = 12Nm
 M6 BOULON = 15Nm
 M8 BOULON = 20Nm
 M10 BOULON = 40Nm



PHOTO 1

NOTICE DE MONTAGE

- Commencez du coté droit, enlever le boulon de fixation moteur avant et la rondelle en utilisant une clé Allen 8mm (voir photo 1).
- Glisser une rondelle 10mm (article 3) sur le boulon M10 x 105mm (article 2) de façon à ce que la rondelle se place contre la tête du boulon.
- Glisser une rondelle de blocage (article 4) sur le boulon de façon à ce qu'il se place contre la rondelle tout juste insérée.
- Glisser ensuite le boulon avec ses rondelles dans l'une des protections crash (article 5) de façon à ce que la tête du boulon et les rondelles se placent dans le contre alésage.
- Placer l'entretoise (Article 5) sur l'extrémité du boulon, en veillant à ce que le diamètre le plus large se place contre la bobine de protection.
- Vérifier que l'ensemble corresponde au schéma présenté en page 1 et monter l'ensemble sur la moto, voir photos en page 1.
- Serrer le boulon de la protection jusqu'à ce que vous sentiez une compression de l'intérieur de la protection avec une clé de 17mm. **LA PROTECTION DOIT ETRE POSITIONNEE COMME EN "C" AVEC LE COTE ARRONDI LE PLUS GROS EN DIRECTION DE L'AVANT DE LA MOTO.** Tourner un peu plus afin d'accentuer légèrement la compression. Faire un quart de tour. Serrer à 40Nm de couple (Ne pas excéder cette valeur, car cela pourrait endommager la moto et le boulon)..
- Répéter la procédure ci-dessus pour installer la protection crash restante du coté gauche de la moto, en utilisant le boulon restant et l'entretoise.
- Si cela n'est pas déjà fait, placez un sticker de caoutchouc dans le creux de la protection crash.
- Placer un capuchon de protection crash (Article 6) dans chacune des protections crash.

R&G Racing

Unit 1, Shelley's Lane, East Worldham, Alton, Hampshire, GU34 3AQ

Tel: +44 (0)1420 89007 Fax: +44 (0)1420 87301 www.rg-racing.com Email: info@rg-racing.com



ISSUE 1 19/04/2017 (HH)

Notice disponible au téléchargement sur www.rg-racing.com

CONSUMER NOTICE

The catalogue description and any exhibition of samples are only broad indications of the Products and R&G may make design changes which do not diminish their performance or visual appeal and supplying them in such state shall conform to the order. The Buyer acknowledges no representation or warranty (other than as to title) has been given or will apply to the Products other than those in R&G's order or confirmation and the Buyer confirms it has chosen the Products as being of merchantable quality and suitable for its particular purposes. Where R&G fits the Products or undertakes other services it shall exercise reasonable skill and care and rectify any fault free of charge unless the workmanship has been disturbed. The Buyer is responsible for ensuring that the warranty on the motorcycle is not affected by the fitting of the Products. On return of any defective Products R&G shall at its option either supply a replacement or refund the purchase money but shall not be liable if the Products have been modified or used or maintained otherwise than in accordance with R&G's or manufacturer's instructions and good engineering practice or if the defect arises from accident or neglect. Other than identified above and subject to R&G not limiting its liability for causing death and personal injury, it shall not be liable for indirect or consequential loss and otherwise its liability shall be limited to the amounts paid by the Buyer for the Products or the fitting or service concerned. These terms do not affect the Buyer's statutory rights.

R&G RACING RETURNS POLICY (NON-FAULTY GOODS)

Returns must be pre-authorized (if not pre-authorized the return will be rejected). Goods may only be returned direct to us if they were purchased direct from us (customer must prove if necessary). Otherwise to be returned to original vendor. Goods must be in re-sellable condition, in the opinion of R&G Racing. All returns are subject to a 25% restocking and handling fee (25% of the gross value exc. P&P – at the prevailing price at time of purchase). The customer must pay any and all carriage charges. No returns of discontinued products, unless within 14 days of purchase. This policy does not affect your statutory rights and does not refer to faulty goods.